

Confezioni di anelli di spessore/Anelli di spessore Standard/Configurabili

Anelli di spessore Standard

Standard, venduti in confezioni (30 pz./)configurabili

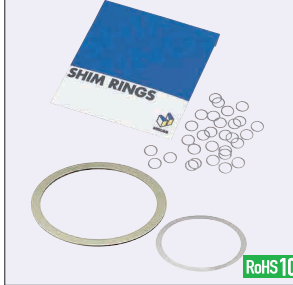

Standard	Configurabili	Materiale	Durezza	Tolleranza spessore (T)									
				0.01	0.05	0.1	0.2	0.3	0.5	0.8	1.0		
PCIMRS	CIMRSF	EN 1.4301 Equiv.	370-430HV	±0.003	±0.005	±0.02	±0.03	±0.035	±0.04	±0.05			
PCIMRB	CIMRBF	Ottone (EN CW505L Equiv. o EN CW507L Equiv.)	-	-	±0.005	±0.02	±0.03	±0.04	±0.05	-	±0.08		
PCIMR	CIMRF	EN 1.0330 Equiv.	-	-	-	±0.03	±0.04	±0.06	-	±0.11			

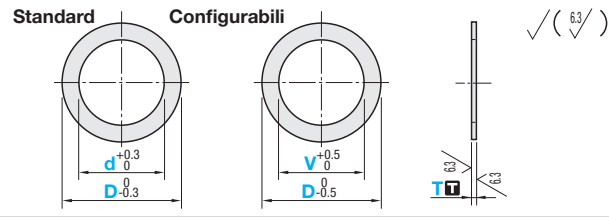

EN 1.4301 Equiv. 30 pz. per confezione

Nessuna specifica disponibile per spessore piastra (T) senza valore dichiarato.

Codice componente	Tipo	d	Selezione D	Selezione T	Prezzo unitario			
					PCIMRS	T0.01, 0.05	T0.1-0.3	T0.5
PCIMRS	2	3	4 5 6					
	3	4	5 6 7 8 9 10					
	4	5	6 7 8 9 10 12 13					
	5	7	8 9 10 12 13 14 15 16					
	6	8	9 10 12 13 14 15 16 18					
	8	10	12 13 14 15 16 18 20					
	10	12	13 14 15 16 18 20					
	12	15	16 18 20 21 22	0.01				
	15	18	20 21 22 24	0.05				
	16	20	21 22 24 28	0.1				
	17	20	21 22 24 28 30 32	0.2				
	20	24	28 30 32 35 40	0.3				
	22	28	30 32	0.5				
	25	30	32 35 40 42	1.0				
	30	35	40 42 45 50					
	35	42	45 50 55					
	40	45	50 55					
	45	50	55					

Ottone, EN 1.0330 Equiv. 30 pz. per confezione

Codice componente	Tipo	d	Selezione D	Selezione T	Prezzo unitario								
					PCIMRB	T0.05	T0.1-0.3	T0.5	T1.0	PCIMR	T0.1-0.3	T0.5	T1.0
PCIMRB	3	5	6 8 10	(0.05)									
	4	6	8 10 12	Solo per PCIMRB									
	5	8	10 12 14	0.1									
	6	10	12 14 16	0.2									
	8	12	14 16	0.3									
	10	14	16 18 20	0.5									
12	16	18 20 21 22	1.0										

Configurabili

Codice componente	Selezione D	V	Selezione T	Prezzo unitario													
				CIMRSF	T0.05	T0.1-0.3	T0.5	T1.0	CIMRBF	T0.05	T0.1-0.3	T0.5	T1.0	CIMRF	T0.1-0.3	T0.5	T1.0
CIMRSF	4.0-20		(0.05)														
	20.5-40		CIMRBF														
	40.5-60	0	Solo per CIMRSF														
	60.5-80	(Senza foro)	(0.8)														
	80.5-100	2.0	Solo per CIMRSF														
	100.5-120	2.6															
	120.5-140																
	140.5-160			0.1													
	160.5-180	3.0-248.0		0.2													
	180.5-200	T≤0.2→V≤D-2		0.3													
200.5-214	0.3≤T→V≤D-3		0.5														
214.5-230	(V2.6→D≥5)		1.0														
230.5-250																	

Ordering Example: PCIMRSS - 12 - 0.1

Ordering Example: CIMRSF - D73 - V43 - T1.0

Alterations: CIMRSF - D22 - V18 - T0.1 - KC

Applicabile solo al tipo con dimensione configurabile.

Variante	Spec.																																				
Gola di scarico per sede chiavetta	Aggiunge una gola di scarico per sede chiavetta. (Codice d'ordine) KC Condizioni di lavorazione 8≤V≤49.5																																				
	<table border="1"> <thead> <tr> <th>V</th> <th>b</th> <th>t</th> <th>D-V</th> </tr> </thead> <tbody> <tr><td>8-10.5</td><td>3</td><td>2.0</td><td>7 o sup.</td></tr> <tr><td>11-12.5</td><td>4</td><td>2.5</td><td>8 o sup.</td></tr> <tr><td>13-17.5</td><td>5</td><td>3.0</td><td>10 o sup.</td></tr> <tr><td>18-22.5</td><td>6</td><td>3.5</td><td>12 o sup.</td></tr> <tr><td>23-30.5</td><td>8</td><td>4.0</td><td>14 o sup.</td></tr> <tr><td>31-38.5</td><td>10</td><td>4.0</td><td>14 o sup.</td></tr> <tr><td>39-42.5</td><td>12</td><td>4.0</td><td>14 o sup.</td></tr> <tr><td>43-49.5</td><td>14</td><td>4.5</td><td>16 o sup.</td></tr> </tbody> </table>	V	b	t	D-V	8-10.5	3	2.0	7 o sup.	11-12.5	4	2.5	8 o sup.	13-17.5	5	3.0	10 o sup.	18-22.5	6	3.5	12 o sup.	23-30.5	8	4.0	14 o sup.	31-38.5	10	4.0	14 o sup.	39-42.5	12	4.0	14 o sup.	43-49.5	14	4.5	16 o sup.
V	b	t	D-V																																		
8-10.5	3	2.0	7 o sup.																																		
11-12.5	4	2.5	8 o sup.																																		
13-17.5	5	3.0	10 o sup.																																		
18-22.5	6	3.5	12 o sup.																																		
23-30.5	8	4.0	14 o sup.																																		
31-38.5	10	4.0	14 o sup.																																		
39-42.5	12	4.0	14 o sup.																																		
43-49.5	14	4.5	16 o sup.																																		

Standard

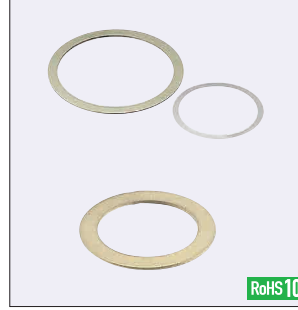

Standard	Materiale	Durezza	Tolleranza spessore (T)									
			0.01	0.02	0.03	0.05	0.1	0.2	0.3	0.5	1.0	
CIMRS	EN 1.4301 Equiv.	370-430HV	±0.003	±0.005	±0.02	±0.03	±0.035	±0.04	±0.05			
CIMRB	Ottone (EN CW505L Equiv. o EN CW507L Equiv.)	-	-	-	±0.005	±0.02	±0.03	±0.04	±0.05	±0.08		
CIMR	EN 1.0330 Equiv.	-	-	-	-	±0.03	±0.04	±0.06	±0.11			

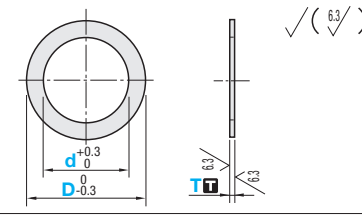

EN 1.4301 Equiv.

Nessuna specifica disponibile per spessore piastra (T) senza valore dichiarato.

Codice componente	Tipo	d	Selezione D	Selezione T	Prezzo unitario			
					CIMRS	T0.01, 0.05	T0.1-0.3	T0.5
CIMRS	2	3	4 5 6					
	3	4	5 6 7 8 9 10					
	4	5	6 7 8 9 10 12 13					
	5	7	8 9 10 12 13 14 15 16					
	6	8	9 10 12 13 14 15 16 18					
	8	10	12 13 14 15 16 18 20					
	10	12	13 14 15 16 18 20					
	12	15	16 18 20 21 22	0.01				
	15	18	20 21 22 24	0.02				
	16	20	21 22 24 28	0.03				
	17	20	21 22 24 28 30 32	0.05				
	20	24	28 30 32 35 40	0.1				
	22	28	30 32 35 40	0.2				
	25	30	32 35 40 42	0.3				
	28	32	35 40 42 45	0.5				
	30	35	40 42 45 50	1.0				
	35	42	45 50 55					
	40	45	50 55					
45	50	55						

Ottone, EN 1.0330 Equiv.

Codice componente	Tipo	d	Selezione D	Selezione T	Prezzo unitario								
					CIMRB	T0.05	T0.1-0.3	T0.5	T1.0	CIMR	T0.1-0.3	T0.5	T1.0
CIMRB	2	4	5 6										
	3	5	6 7 8 10										
	4	6	7 8 10 12										
	5	7	8 10 12 14 16										
	6	8	10 12 14 16										
	8	12	14 16 18 20										
	10	12	14 16 18 20										
	12	16	18 20 21 22										
	15	18	20 21 22 24										
	16	20	21 22 24 28										
	17	20	21 22 24 28 30 32										
	20	24	28 30 32 35 40										
	22	28	30 32 35 40										
	25	30	32 35 40 42										
	28	32	35 40 42 45										
	30	35	40 42 45 50										
	35	42	45 50 55										
	40	45	50 55										
45	50	55											

Ordering Example: CIMRSS - 12 - 0.1