

# Maniglie ad arco/Maniglie in resina fenolica

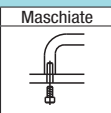

# Maniglie - Non in metallo/A T

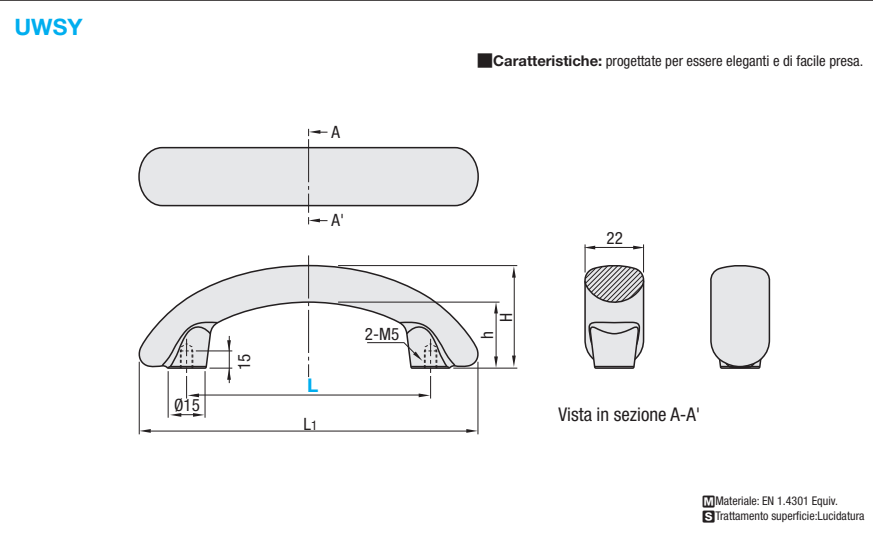
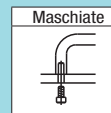

Codice componente	L	L1	H	h	Carico ammesso (N)	Massa (g)	Prezzo unitario
UWSY	100	138	42	27	500	351	
	150	190	44	29		448	

Ordering Example  
Codice componente UWSY100

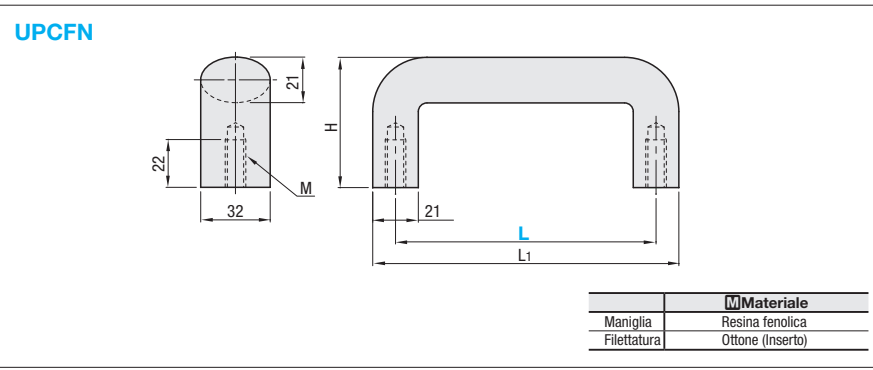
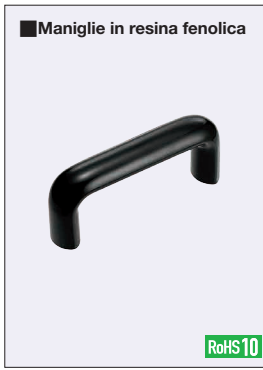

Codice componente	L	L1	M	H	Massa (g)	Carico ammesso (N)	Prezzo unitario
UPCFN	90	110	6	50	90	1100	
	114	132			105	1100	
	120	142			140	700	
	140	162	8	60	155	600	
	160	182			170	600	
	180	202			200	500	
	200	222		210	470		

Ordering Example  
Codice componente UPCFN114

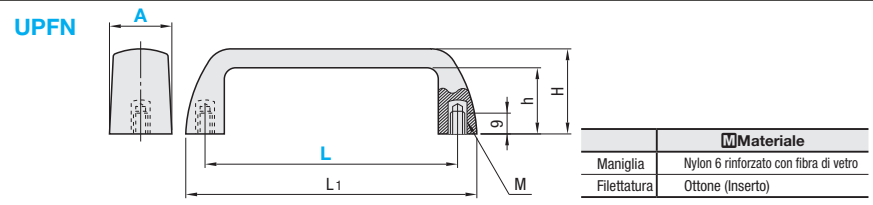

Codice componente	L	Colore maniglia	L1	H	h	M (Fil. grossa)	Carico ammesso (N)	Massa (g)	Prezzo unitario
UPFN	26	105	121	37	29	6	500	55	
		110						60	
		117						62	

Il colore maniglia predefinito è il nero, se non altrimenti specificato.  
Ordering Example UPFN26 - 105 - B

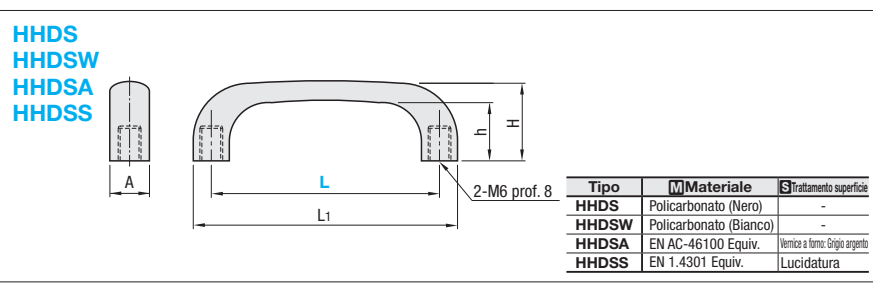

Codice componente	L1	H	h	A	Massa (g)			Prezzo unitario				
Tipo	L				HHDS	HHDSW	HHDSA	HHDS	HHDS	HHDSW	HHDSA	HHDS
HHDS	90	110	32	24	13	17	43	90				
HHDSW	104	127	37	27.7	16	25	65	150				
HHDS	122	149	43.3	32.5	19	42	102	220				

Carico ammesso non disponibile per le maniglie per montaggio su pannelli.

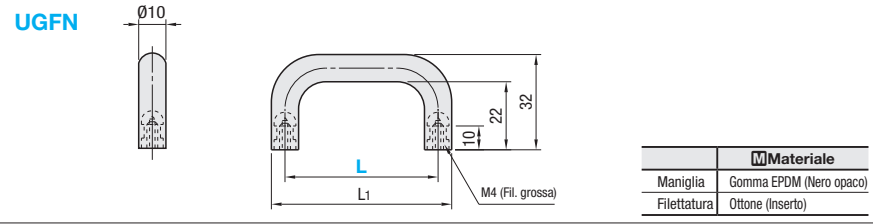

Codice componente	L	L1	Massa (g)	Prezzo unitario
UGFN (Gomma)	40	50	10	
	53	63	12	
	70	80	15	

Carico ammesso non fornito in quanto impossibile da misurare.

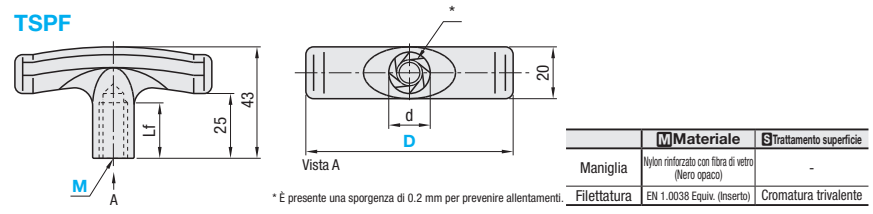

Codice componente	D	M	Lf	d	Massa (g)	Prezzo unitario
TSPF	50	3	20	11	26	
		4			28	
		5			30	
	80	5	25	16	46	
		6			50	
		8			56	

Ordering Example  
Codice componente HHDS90 UGFN70 TSPF50 - 4