

Dies Steel
SKD61 equivalent
+
Nitriding

STRAIGHT EJECTOR PINS WITH TIP PROCESS

— L DIMENSION DESIGNATION TYPE —

L dimension designation type

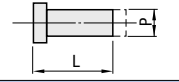

Ⓢ Non JIS material definition is listed on P.1351 - 1352

RoHS

Select a tip shape **P.93~96**

Ⓢ To determine the shape position, key flat cutting is made at the standard 0°

Part Number	Head thickness	T	P
EPN□A	4mm(T4)	0 -0.02	-0.01 -0.02
EPJ□A	6・8mm(JIS)	0 -0.05	-0.01 -0.02

Range of guaranteed shaft diameter precision (Details **P.1301**)

Head Thickness (T)	L	x1 max.
T4	50.00~300.00	30
JIS		35
T4	300.01~350.00	210
JIS		

M SKD61 equivalent+Nitrided
F Surface base:900HV~
 Base material:40~45HRC
 Range of guaranteed base material hardness (Details **P.1303**)
 Range of guaranteed surface hardness for nitriding (Details **P.1303**)

4mm head		JIS head		Part Number			0.01mm increments		
H	T	H	T	Type		Tip shapes	P	L	
				4mm head	JIS Head				
3	4	—	—	EPN	—	1A 11A 21A 31A 2A 12A 22A 32A 3A 13A 23A 4A 14A 24A 5A 15A 25A 6A 16A 26A 7A 17A 27A 8A 18A 28A 9A 19A 29A 10A 20A 30A	1.5	50.00~200.00	
4							2	50.00~250.00	
5							2.5	50.00~300.00	
6							3		
7							3.5		
8							4		
8							4.5		
9							5		
9							5.5		
10							6		
10							6.5		
11							7		
11							7.5		
15							8	50.00~350.00	
15							8	10	
17							17	12	

Ⓢ The shaped tip has the same hardness as its base material.
 Ⓢ Select the tip shape 1A~32A **P.93~96**.
 Ⓢ For JIS head type less than P4 is T=4, please place the order for 4mm head type of EPN□A

Order Part Number — L — Sequence of A/V/E/J/W/R/SR/F/G/K/Q

Type Tip shapes P — L — Sequence of A/V/E/J/W/R/SR/F/G/K/Q

EPJ 2A 10 — 200.00 — V5.0 — G70

Days to Ship **Quotation**

Alterations Part Number — L — A・V・E・J・W・R・SR・F・G・K・Q — (AKC・AWC...etc.)

EPJ2A 10 — 200.00 — V5.0 — G70 — TC6

Alterations	Code	Spec.	1Code
	AKC	AKC=1° increments Ⓢ 0 < AKC < 360 Ⓢ No need to designate AKCO	
	AWC	AWC=1° increments Ⓢ 0 ≤ AWC < 360	
	ARC	ARC=1° increments Ⓢ 0 ≤ ARC < 360	Quotation
	ADC	ADC=1° increments Ⓢ 0 ≤ ADC < 360	
	KGA	KGA=1° increments Ⓢ 0 < KGA < 360	
	KGB	KGB=1° increments Ⓢ 0 < KGB < 360	

P Price **Quotation**

Alteration details **P.53**

Alterations	Code	Spec.	1Code
	KAC	Varied width parallel flats cutting P/2 ≤ KAC < H/2 KBC=0.1mm increments only KAC < KBC < H/2 Ⓢ Combination with other key flat cutting not available	
	KBC		
	HC	HC=0.1mm increments Ⓢ P+1 ≤ HC < H	
	TC	TC=0.1mm increments Ⓢ T/2 ≤ TC < T (Dimensions L and F remain unchanged) Ⓢ T - TC ≤ Lmax. - L	Quotation
	NHC	Numbering on the head How to order P.54	
	NHN	Automatic sequential numbering on the head How to order P.54	
	NKC	Without key flat cutting Ⓢ Available for tip shapes 6A・9A・11A・12A・13A・30A Ⓢ Combination only with HC・TC・NHC・NHN available.	

Straight Ejector Pins

Dies Steel SKD61 equivalent + Nitriding